

齒輪式半自動稀油泵

PLC Control Oil Pump



功能特點 Features

- 配有液位報警和壓力報警（可選配）。當油量或壓力不足時可將異常信號輸出。
- 面板指示燈可顯示出注油機的通電和潤滑狀態。
- 電機設自我保護功能，防止電機溫度過高導致過載。
- 配合容積式分配器或抵抗式分配器使用。
- 設有溢流閥，可保護注油機及管路由于壓力過高而損壞。
- 與機床直接聯動。
- Equipped with level switch(optional), an alarm can be issued when short of oil.
- Equipped with pressure switch(optional), an alarm can be issued when short of pressure.
- The indicator lights can show the working status.
- The motor is equipped with a self-protection function to prevent overload caused by excessive motor temperature.
- Use with detective volumetric oil distributors and resistance oil distributors.
- Equipped with relief valve to protect the lubricator and pipeline.
- Equipped with a fuse inside to prevent the main board and motor from being burnt due to excessive current.
- PLC Control.

尺寸圖

Dimensional drawings

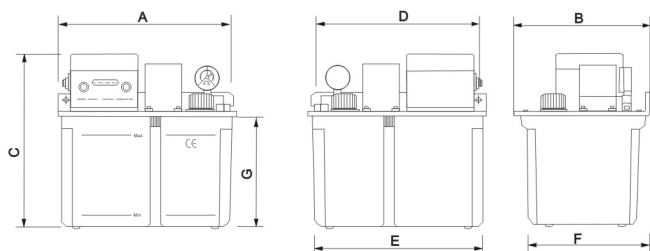

規格表

Specifications

型號 Model	A(mm)	B(mm)	C(mm)	D(mm)	E(mm)	F(mm)	G(mm)
1 Liter	175	120	202	115	138	98	108
1.5 Liter	168	115	256	155	165	109	130
2 Liter	208	130	283	189	220	126	150
3 Liter	210	150	265	189	220	126	155
4 Liter	280	168	245	265	260	150	157
5 Liter	305	168	245	265	260	150	157
6 Liter	320	168	245	265	260	150	157
8 Liter	300	240	250	340	300	220	150
20 Liter	445	280	300	415	425	300	210

型號 Model	TZ2204	TZ2234	TZ2264
容量 Reservoir capacity	2L/4L/8L/20L	2L/4L/8L/20L	2L/4L/8L/20L
控制方式 Control type	PLC	Timer	Timer
用脂範圍 Lubricant Viscosity	30-1200 CST.	30-1200 CST.	30-1200 CST.
電壓 Voltage	380V	380V	380V
功率 Power	45W	45W	45W
最高工作壓力 Max.pressure	2.5MPa	2.5MPa	2.5MPa
流量 Discharge volume	150CC/MIN	150CC/MIN	150CC/MIN
程控器 Digital display	×	Single line digit	Double line digit
液位報警 Level switch	✓	✓	✓
壓力報警 Pressure relief valve	选配 Optional	选配 Optional	选配 Optional
出油口規格 Outlet thread	M10X1 (卡套式 C6)	M10X1 (卡套式 C6)	M10X1 (卡套式 C6)

齒輪式半自動稀油泵

PLC Control Oil Pump



功能特點 Features

- 配有液位報警和壓力報警（可選配）。當油量或壓力不足時可將異常信號輸出。
- 面板指示燈可顯示出注油機的通電和潤滑狀態。
- 電機設自我保護功能，防止電機溫度過高導致過載。
- 配合容積式分配器或抵抗式分配器使用。
- 設有溢流閥，可保護注油機及管路由于壓力過高而損壞。
- 與機床直接聯動。
- Equipped with level switch(optional), an alarm can be issued when short of oil.
- Equipped with pressure switch(optional), an alarm can be issued when short of pressure.
- The indicator lights can show the working status.
- The motor is equipped with a self-protection function to prevent overload caused by excessive motor temperature.
- Use with detective volumetric oil distributors and resistance oil distributors.
- Equipped with relief valve to protect the lubricator and pipeline.
- Equipped with a fuse inside to prevent the main board and motor from being burnt due to excessive current.
- PLC Control.

尺寸圖

Dimensional drawings

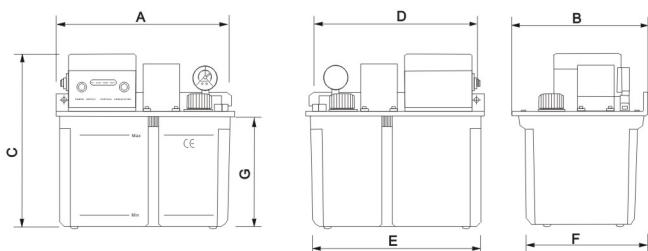

規格表

Specifications

型號 Model	A(mm)	B(mm)	C(mm)	D(mm)	E(mm)	F(mm)	G(mm)
1 Liter	175	120	202	115	138	98	108
1.5 Liter	168	115	256	155	165	109	130
2 Liter	208	130	283	189	220	126	150
3 Liter	210	150	265	189	220	126	155
4 Liter	280	168	245	265	260	150	157
5 Liter	305	168	245	265	260	150	157
6 Liter	320	168	245	265	260	150	157
8 Liter	300	240	250	340	300	220	150
20 Liter	445	280	300	415	425	300	210

型號 Model	TZ2202	TZ2232	TZ2262
容量 Reservoir capacity	1/2/3/4/5/6/8/20L	1/2/3/4/5/6/8/20L	2/3/4/5/6/8/20L
控制方式 Control type	PLC	Timer	Timer
用脂範圍 Lubricant Viscosity	30-1200 CST.	30-1200 CST.	30-1200 CST.
電壓 Voltage	110V/220V	110V/220V	110V/220V
功率 Power	25W	25W	25W
最高工作壓力 Max.pressure	2.5MPa	2.5MPa	2.5MPa
流量 Discharge volume	140CC/MIN	140CC/MIN	140CC/MIN
程控器 Digital display	×	Single line digit	Double line digit
液位報警 Level switch	✓	✓	✓
壓力報警 Pressure relief valve	选配 Optional	选配 Optional	选配 Optional
出口口規格 Outlet thread	M10X1 (卡套式 C6)	M10X1 (卡套式 C6)	M10X1 (卡套式 C6)

齒輪式全自動稀油泵

Fully Automatic Oil Pump

功能特點 Features

- 配有液位報警和壓力報警（可選配）。當油量或壓力不足時可將異常信號輸出。ERP顯示壓力不足，ERO顯示液位不足。
- 面板指示燈可顯示出注油機的通電和潤滑狀態。
- 電機設自我保護功能，防止電機溫度過高導致過載。
- 配合容積式分配器或抵抗式分配器使用。
- 設有溢流閥，可保護注油機及管路由于壓力過高而損壞。
- 內部配有保險絲防止因短路導致電流過大燒壞主板和電機。
- 潤滑時間和間隙時間均可調整，潤滑時間1-999（秒），間隙時間1-999（分/秒）可轉換。
- Equipped with level switch(optional), an alarm can be issued when short of oil.
- Equipped with pressure switch(optional), an alarm can be issued when short of pressure.
- The indicator lights can show the working status.
- The motor is equipped with a self-protection function to prevent overload caused by excessive motor temperature.
- Use with detective volumetric oil distributors and resistance oil distributors.
- Equipped with relief valve to protect the lubricator and pipeline.
- Equipped with a fuse inside to prevent the main board and motor from being burnt due to excessive current.
- Lubricating time and intermittent time can be adjusted, lubricating time range from 1-999 seconds, intermittent time range from 1-999 seconds/minutes.

尺寸圖

Dimensional drawings

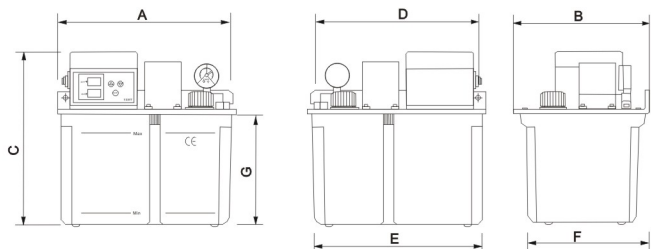

規格表

Specifications

型號 Model	A(mm)	B(mm)	C(mm)	D(mm)	E(mm)	F(mm)	G(mm)
1 Liter	175	120	202	115	138	98	108
1.5 Liter	168	115	256	155	165	109	130
2 Liter	208	130	283	189	220	126	150
3 Liter	210	150	265	189	220	126	155
4 Liter	280	168	245	265	260	150	157
5 Liter	305	168	245	265	260	150	157
6 Liter	320	168	245	265	260	150	157
8 Liter	300	240	250	340	300	220	150
20 Liter	445	280	300	415	425	300	210

型號 Model	TZ2202	TZ2232	TZ2262
容量 Reservoir capacity	1/2/3/4/5/6/8/20L	1/2/3/4/5/6/8/20L	2/3/4/5/6/8/20L
控制方式 Control type	PLC	Timer	Timer
用脂範圍 Lubricant Viscosity	30-1200 CST.	30-1200 CST.	30-1200 CST.
電壓 Voltage	110V/220V	110V/220V	110V/220V
功率 Power	25W	25W	25W
最高工作壓力 Max.pressure	2.5MPa	2.5MPa	2.5MPa
流量 Discharge volume	140CC/MIN	140CC/MIN	140CC/MIN
程控器 Digital display	×	Single line digit	Double line digit
液位報警 Level switch	✓	✓	✓
壓力報警 Pressure relief valve	选配 Optional	选配 Optional	选配 Optional
出口口規格 Outlet thread	M10X1 (卡套式 C6)	M10X1 (卡套式 C6)	M10X1 (卡套式 C6)

齒輪式全自動稀油泵

Fully Automatic Oil Pump

功能特點 Features



- 配有液位報警和壓力報警（可選配）。當油量或壓力不足時可將異常信號輸出。ERP顯示壓力不足，ERO顯示液位不足。
- 面板指示燈可顯示出注油機的通電和潤滑狀態。
- 配合容積式分配器或抵抗式分配器使用。
- 設有溢流閥，可保護注油機及管路由于壓力過高而損壞。
- 潤滑時間和間隙時間均可調整，潤滑時間1-999（秒），間隙時間1-999（分/秒）可轉換。
- Equipped with level switch(optional), an alarm can be issued when short of oil.
- Equipped with pressure switch(optional), an alarm can be issued when short of pressure.
- The indicator lights can show the working status.
- The motor is equipped with a self-protection function to prevent overload caused by excessive motor temperature.
- Use with detective volumetric oil distributors and resistance oil distributors.
- Equipped with relief valve to protect the lubricator and pipeline.
- Equipped with a fuse inside to prevent the main board and motor from being burnt due to excessive current.
- Lubricating time and intermittent time can be adjusted, lubricating time range from 1-999 seconds, intermittent time range from 1-999 seconds/minutes.

尺寸圖

Dimensional drawings

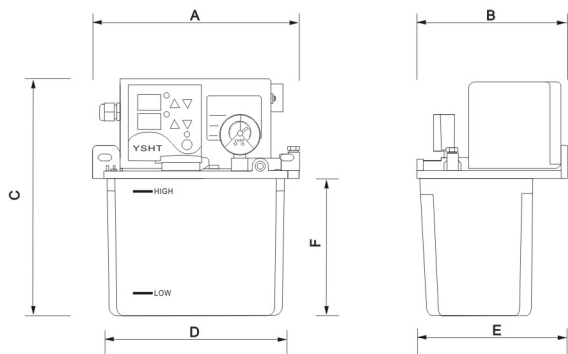

型號 Model	A(mm)	B(mm)	C(mm)	D(mm)	E(mm)	F(mm)
2 Liter	205	138	250	168-185	138	150
3 Liter	228	165	270	175-210	165	150
4 Liter	295	170	270	248-282	170	150
8 Liter	352	210	330	338	210	150

規格表

Specifications

型號 Model	YET-A1/A2	YET-A1P1/A2P2
容量 Reservoir capacity	2L/3L/4L/8L	2L/3L/4L/8L
控制方式 Control type	Timer	Timer
用脂範圍 Lubricant Viscosity	30-1200 CST.	30-1200 CST.
電壓 Voltage	24V/110V/220V	24V/110V/220V
功率 Power	100W	100W
最高工作壓力 Max.pressure	2.5MPa	2.5MPa
流量 Discharge volume	150CC/MIN	150CC/MIN
程控器 Digital display	✓	✓
液位報警 Level switch	✓	✓
壓力報警 Pressure relief valve	×	✓
出油口規格 Outlet thread	M10X1 (卡套式 C6)	M10X1 (卡套式 C6)

齒輪式半自動稀油泵

PLC Control Oil Pump



功能特點 Features

- 配有液位報警和壓力報警（可選配）。當油量或壓力不足時可將異常信號輸出。ERP顯示壓力不足，ERO顯示液位不足。
- 面板指示燈可顯示出注油機的通電和潤滑狀態。
- 電機設自我保護功能，防止電機溫度過高導致過載。
- 配合容積式分配器或抵抗式分配器使用。
- 設有溢流閥，可保護注油機及管路由于壓力過高而損壞。
- Equipped with level switch(optional), an alarm can be issued when short of oil.
- Equipped with pressure switch(optional), an alarm can be issued when short of pressure.
- The indicator lights can show the working status.
- The motor is equipped with a self-protection function to prevent overload caused by excessive motor temperature.
- Use with detective volumetric oil distributors and resistance oil distributors.
- Equipped with relief valve to protect the lubricator and pipeline.
- Equipped with a fuse inside to prevent the main board and motor from being burnt due to excessive current.
- PLC Control.

尺寸圖

Dimensional drawings

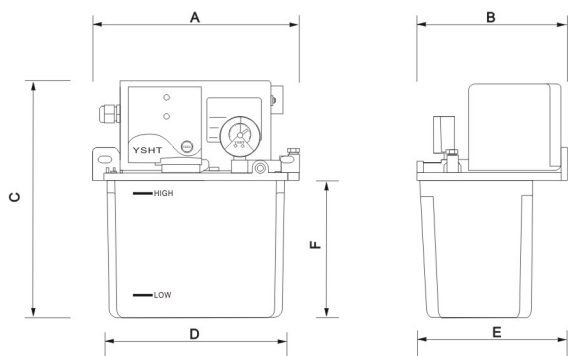

型號 Model	A(mm)	B(mm)	C(mm)	D(mm)	E(mm)	F(mm)
2 Liter	205	138	250	168-185	138	150
3 Liter	228	165	270	175-210	165	150
4 Liter	295	170	270	248-282	170	150
8 Liter	352	210	330	338	210	150

規格表

Specifications

型號 Model	YET-B2/C2	YET-B2P2/C2P2
容量 Reservoir capacity	2L/3L/4L/8L	2L/3L/4L/8L
控制方式 Control type	PLC	PLC
用脂範圍 Lubricant Viscosity	30-1200 CST.	30-1200 CST.
電壓 Voltage	24V/110V/220V	24V/110V/220V
功率 Power	100W	100W
最高工作壓力 Max.pressure	2.5MPa	2.5MPa
流量 Discharge volume	150CC/MIN	150CC/MIN
程控器 Digital display	×	×
液位報警 Level switch	✓	✓
壓力報警 Pressure relief valve	×	✓
出油口規格 Outlet thread	M10X1 (卡套式 Ø6)	M10X1 (卡套式 Ø6)

連續型半自動稀油泵

Continuously Workable PLC Control Oil Pump

功能特點 Features



- 配有液位報警和壓力報警（可選配）。當油量或壓力不足時可將異常信號輸出。
- 面板指示燈可顯示出注油機的通電和潤滑狀態。
- 電機設自我保護功能，防止電機溫度過高導致過載。
- 配合容積式分配器或抵抗式分配器使用。
- 設有溢流閥，可保護注油機及管路由于壓力過高而損壞。
- 與機床直接聯動。
- 電機可連續運轉。
- Equipped with level switch(optional), an alarm can be issued when short of oil.
- Equipped with pressure switch(optional), an alarm can be issued when short of pressure.
- The indicator lights can show the working status.
- The motor is equipped with a self-protection function to prevent overload caused by excessive motor temperature.
- Use with detective volumetric oil distributors and resistance oil distributors.
- Equipped with relief valve to protect the lubricator and pipeline.
- Equipped with a fuse inside to prevent the main board and motor from being burnt due to excessive current.
- PLC Control, Can continuously work.

尺寸圖

Dimensional drawings

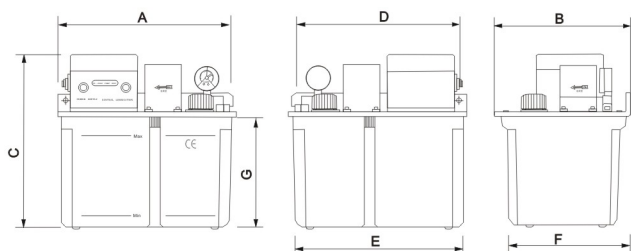

型號 Model	A(mm)	B(mm)	C(mm)	D(mm)	E(mm)	F(mm)	G(mm)
2 Liter	208	130	283	189	220	126	150
4 Liter	280	168	245	265	260	150	157
8 Liter	300	240	250	340	300	220	150
20 Liter	445	280	300	415	425	300	210

規格表

Specifications

型號 Model	YAC-B2	YAC-B2P2
容量 Reservoir capacity	4L/8L/20L	4L/8L/20L
控制方式 Control type	PLC	PLC
用脂範圍 Lubricant Viscosity	30-1200 CST.	30-1200 CST.
電壓 Voltage	220V	220V
功率 Power	100W	100W
最高工作壓力 Max.pressure	2.5MPa	2.5MPa
流量 Discharge volume	180CC/MIN	180CC/MIN
程控器 Digital display	×	×
液位報警 Level switch	✓	✓
壓力報警 Pressure relief valve	×	✓
出油口規格 Outlet thread	M10X1 (卡套式 \varnothing 6)	M10X1 (卡套式 \varnothing 6)

連續型全自動稀油泵

Continuously Workable Fully Automatic Oil Pump

功能特點 Features



- 配有液位報警和壓力報警（可選配）。當油量或壓力不足時可將異常信號輸出。ERP顯示壓力不足，ERO顯示液位不足。
- 面板指示燈可顯示出注油機的通電和潤滑狀態。
- 電機設自我保護功能，防止電機溫度過高導致過載。
- 配合容積式分配器或抵抗式分配器使用。
- 設有溢流閥，可保護注油機及管路由于壓力過高而損壞。
- 電機可連續運轉。
- 潤滑時間和間隙時間均可調整，潤滑時間1-999（秒），間隙時間1-999（分/秒）可轉換。
- Equipped with level switch(optional), an alarm can be issued when short of oil.
- Equipped with pressure switch(optional), an alarm can be issued when short of pressure.
- The indicator lights can show the working status.
- The motor is equipped with a self-protection function to prevent overload caused by excessive motor temperature.
- Use with detective volumetric oil distributors and resistance oil distributors.
- Equipped with relief valve to protect the lubricator and pipeline.
- Can continuously work
- Lubricating time and intermittent time can be adjusted, lubricating time range from 1-999 seconds, intermittent time range from 1-999 seconds/minutes.

尺寸圖

Dimensional drawings

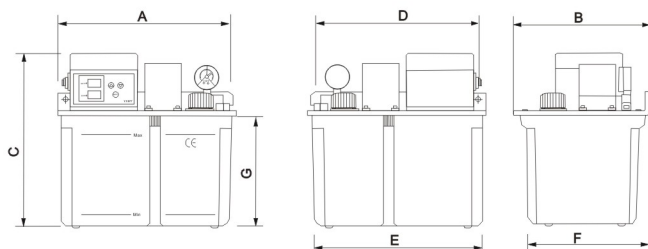

型號 Model	A(mm)	B(mm)	C(mm)	D(mm)	E(mm)	F(mm)	G(mm)
2 Liter	208	130	283	189	220	126	150
4 Liter	280	168	245	265	260	150	157
8 Liter	300	240	250	340	300	220	150
20 Liter	445	280	300	415	425	300	210

型號 Model	YAE-A2	YAE-A2P2
容量 Reservoir capacity	4L/8L/20L	4L/8L/20L
控制方式 Control type	Timer	Timer
用脂範圍 Lubricant Viscosity	30-1200 CST.	30-1200 CST.
電壓 Voltage	220V	220V
功率 Power	100W	100W
最高工作壓力 Max.pressure	2.5MPa	2.5MPa
流量 Discharge volume	180CC/MIN	180CC/MIN
程控器 Digital display	✓	✓
液位報警 Level switch	✓	✓
壓力報警 Pressure relief valve	×	✓
出油口規格 Outlet thread	M10X1 (卡套式 C6)	M10X1 (卡套式 C6)

全自動稀油泵

Fully Automatic Oil Pump

規格表

Specifications



型號 Model	TZ2232-410X	TZ2202-410X
容量 Reservoir capacity	4L/8L	4L/8L
控制方式 Control type	Timer	PLC
用脂範圍 Lubricant Viscosity	30-1200 CST.	30-1200 CST.
電壓 Voltage	220V/110V	220V/110V
功率 Power	100W	100W
最高工作壓力 Max.pressure	2.5MPa	2.5MPa
流量 Discharge volume	180CC/MIN	180CC/MIN
程控器 Digital display	✓	×
液位報警 Level switch	✓	✓
壓力報警 Pressure relief valve	✓	✓
出油口規格 Outlet thread	M10X1 (卡套式 C6)	M10X1 (卡套式 C6)

Equipped with level switch(optional), an alarm can be issued when short of oil.

Equipped with pressure switch(optional), an alarm can be issued when short of pressure.

The indicator lights can show the working status.

The motor is equipped with a self-protection function to prevent overload caused by excessive motor temperature.

Use with detective volumetric oil distributors and resistance oil distributors.

Equipped with relief valve to protect the lubricator and pipeline.

Lubricating time and intermittent time can be adjusted, lubricating time range from 1-999 seconds, intermittent time range from 1-999 seconds/minutes.

尺寸圖

Dimensional drawings

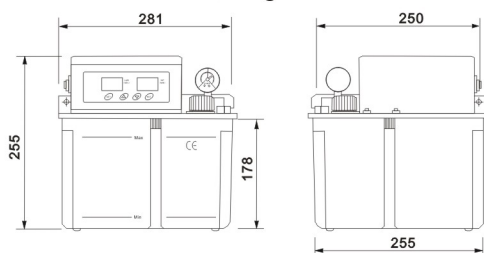

間歇泵/電磁泵

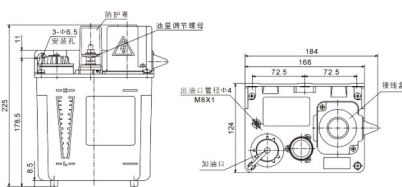

型號 Model	TM6*
容量 Reservoir capacity	1.8L
間歇時間 Intermittent Timer (min)	15min/30min/60min
電壓 Voltage	220V/110V
功率 Power	4W
最高工作壓力 Max.pressure	0.3MPa
流量 Discharge volume	55CC/MIN
液位報警 Level switch	✓
壓力報警 Pressure relief valve	✓
出油口規格 Outlet thread	M8X1 (卡套式 C4)

功能特點 Features



型號 Model	EP2262	DC1100/2200
容量 Reservoir capacity	1L/2L	×
控制方式 Control type	Timer	PLC
用脂範圍 Lubricant Viscosity	46-68CST.	46-68CST.
電壓 Voltage	220V	110V/220V
功率 Power	25W	25W
最高工作壓力 Max.pressure	1.2MPa	1.2MPa
流量 Discharge volume	110CC/MIN	110CC/MIN
程控器 Digital display	✓	×
液位報警 Level switch	✓	×
壓力報警 Pressure relief valve	×	×
出油口規格 Outlet thread	M8X1 (卡套式 C4)	M8X1 (卡套式 C4)

- 全自動數顯設置電磁泵。
- 壓力低，出油量準確。
- 設有低油位報警信號。
- 配合抵抗式分配器使用。
- 適用於潤滑系統較簡單的機械。
- Use Oil 46-68cst.
- Use Resistant distributor.
- Easy to operate.



手動黃油泵/稀油泵

Hand Operated Oil Pump

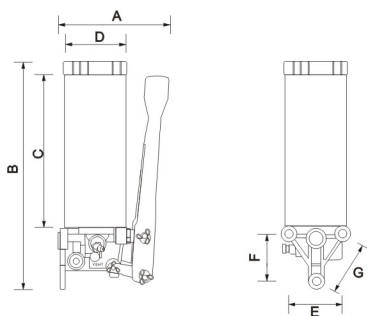

型號 Model	A(mm)	B(mm)	C(mm)	D(mm)	E(mm)	F(mm)	G(mm)
CLHA-10	125	320	150	70	70	85	85
CLHA-20	125	320	170	85	70	85	85
CLHA-30	125	320	210	85	70	85	85
CLHP-160	146	306	190	111	70	85	85

功能特點 Features

- 具良好密封度之壓油鐵，使油料不殘留于杯內。
- 成本經濟，適用之機械設備多元，實用性高。
- 以把手反覆操作送油，操作簡便。
- 適用之黃油黏度為NLGI 0號、00號、000號。
- Use grease NLGI No.000-1.
- Refill with grease gun only.
- Repeated operation, easy to operate.

型號 Model	CLHA-10	CLHA-20	CLHA-30	CLHP-160
容量 Reservoir capacity	0.3L	0.6L	0.8L	1.6L
用脂範圍 Lubricant Viscosity	00-1#	00-1#	00-1#	00-2#
最高工作壓力 Max.pressure	10Mpa	10Mpa	10Mpa	15Mpa
流量 Discharge volume	1.2CC	1.2CC	1.8CC	2.2CC
出油口規格 Outlet thread	M10*1	M10*1	M10*1	M10*1

手搖式注油機

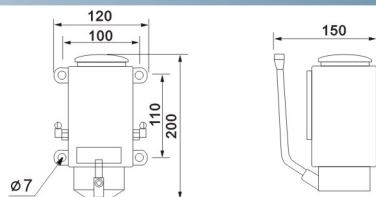

型號 Model	Y-6	Y-8
容量 Reservoir capacity	350	500
用脂範圍 Lubricant Viscosity	30-68CST.	30-68CST.
最高工作壓力 Max.pressure	1.5Mpa	1.5Mpa
流量 Discharge volume	6	8
出油口規格 Outlet thread	M10*1(default)	M10*1(default)

手拉式注油機

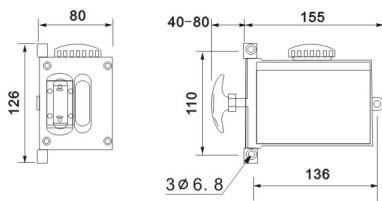

型號 Model	LSP-8	HD-3
容量 Reservoir capacity	600	100
用脂範圍 Lubricant Viscosity	20-150CST.	20-150CST.
最高工作壓力 Max.pressure	0.35Mpa	0.35Mpa
流量 Discharge volume	8	4
出油口規格 Outlet thread	M10*1(default)	M10*1(default)

手拉式注油機

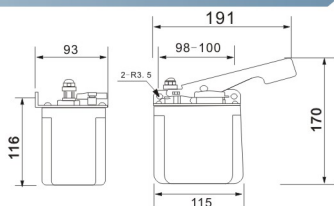

功能特點 Features

- 體積小、安裝方便、使用簡易。Use Oil 46-68cst.
配合抵抗式分配器使用。Use Resistant distributor.
適用於潤滑系統較簡單的機械。easy to operate.

型號 Model	容量 Reservoir capacity	用脂範圍 Lubricant Viscosity	最高工作壓力 Max.pressure	流量 Discharge volume	手壓形式 Operation	出油口規格 Outlet thread
HP-5L	500	30-68CST.	1.5Mpa	3-5CC	Left	4mm or 6mm
HP-5R	500	30-68CST.	1.5Mpa	3-5CC	Right	4mm or 6mm
HP-5M	500	30-68CST.	1.5Mpa	3-5CC	Middle	4mm or 6mm

鐵殼直結馬達電機泵組

Gerotor Pump

功能特點 Features

- 該泵結構簡單，自吸性能強，輸油平穩，噪音低，具有良好的高轉速特性，適用於潤滑系統中的低、壓循環連續冷卻潤滑系統。
- 適用品油黏度：30 ~ 150cSt 干净的導軌油或
- The pump has simple structure, strong self-priming performance, stable output.
- Low noise and good high-speed characteristics.
- suitable for low pressure circulating continuous cooling and lubrication system.

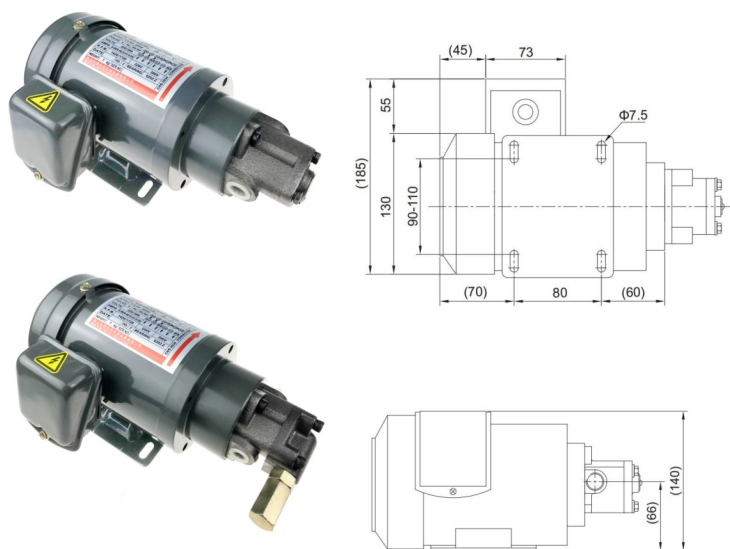

Model	流量/分钟	压力/cm2	噪音值	电压	油口2-RC	总长L	功率	回转速	泵形式
NOP-220/380-12A	1-6.5L/Min	5KG	52dba	380V	PT1/4	300mm	190W	1450R/MIN	不带调压
NOP-220/380-12AVB	1-6.5L/Min	5KG	52dba	380V	PT1/4	300mm	190W	1450R/MIN	带调压
NOP-220/380-13A	1-7.5L/Min	5KG	52dba	380V	PT1/4	300mm	190W	1450R/MIN	不带调压
NOP-220/380-13AVB	1-7.5L/Min	5KG	52dba	380V	PT1/4	300mm	190W	1450R/MIN	带调压

三角擺綫泵/帶調壓擺綫泵/雙向擺綫泵

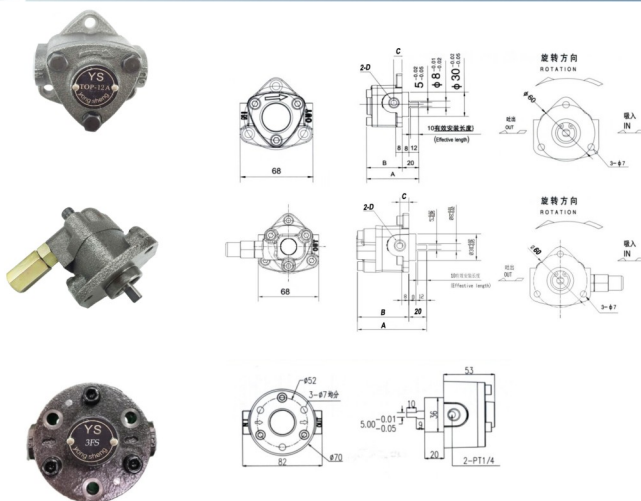

Model	吐油量 (L/min)		最高压力	最高回转速	A		B		C		D		所需动力 W
	1450rpm	1800rpm	kgf/cm2	rpm	无调压	带调压	无调压	带调压	无调压	带调压	无调压	带调压	
TOP10A(VB)	1.2	1.44	5	2200	54	72	34	52	10	10	RC1/8	RC1/8	80
TOP11A(VB)	2.2	2.7	5	2000	58	76	38	56	10	10	RC1/8	RC1/8	100
TOP12A(VB)	3.7	4.5	5	1800	64	82	44	62	10	10	RC1/4	RC1/4	120
TOP13A(VB)	6.5	7.5	5	1800	74	92	54	72	12	12	RC3/8	RC3/8	180

Model	吐油量 (L/min)		最高压力	最高回转速	A	口径 E	所需动力 W
	1500rpm	1800rpm	kgf/cm2	rpm			
2FS	2.7	3.24	5	2000	50	PT1/4	80
3FS	3.75	4.5	5	2000	55	PT1/4	100

重油邦浦

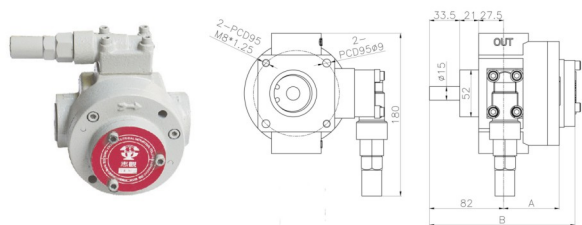

Model	吐油量 (L/min)		最高压力	最高回转速	口径 E	A	B
	1500rpm	1800rpm	kgf/cm2	rpm			
TK-1504	6	7.2	20	2000	3/4PT	62	78
TK-1506	9	10.8	20	2000	1/2PT 3/4PT	67	78
TK-1508	13.5	16.2	20	2000	1/2PT 3/4PT	71	78
TK-3015	22.5	27	25	2000	1"PT	57	155
TK-3020	30	36	25	2000	1"PT	62	160
TK-3030	45	54	25	2000	1"PT	72	170
TK-3040	60	72	25	2000	1"PT	77	175

重油馬達組

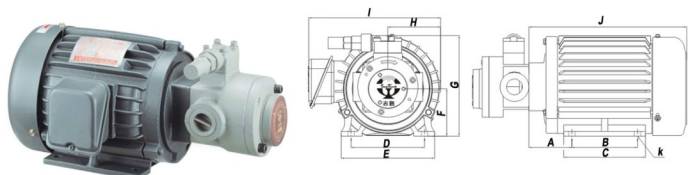

Model	B	C	D	E	F	H	K	M	R	T	Z
1HP	73	100	121	156	125	225	86	172	80	10	252
2HP	75	125	157	175	140	248	100	188	90	12	284
3HP	82	125	157	176	140	248	100	188	90	12	298

稀油容積式分配器

Detective volumetric distributor

DT脫壓定量出油 Positive Displacement Injector System Distributor

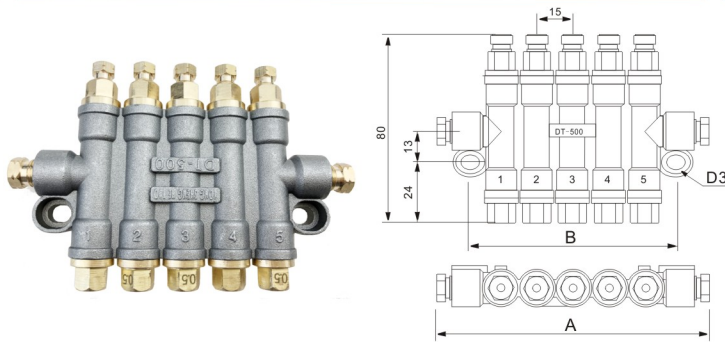

型號 Model	出油口數 Outlets	流量 Flow rate	重量(g) Weight	A	B
DT-200	2	0.06 0.1 0.2 0.3 0.4 0.5	168	78	39
DT-300	3		232	93	54
DT-400	4		299	108	69
DT-500	5		359	123	84
DT-600	6		400	138	99

DGG加壓定量出油 Positive Displacement Injector System Distributor

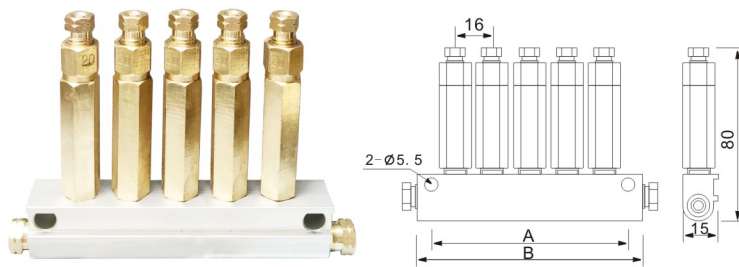

型號 Model	出油口數 Outlets	流量 Flow rate	重量(g) Weight	A	B
DGG-100	1	0.06 0.16 0.2 0.3 0.4 0.5	83	7	35
DGG-200	2		127	36	49
DGG-300	3		178	52	65
DGG-400	4		232	68	81
DGG-500	5		283	84	97
DGG-600	6		339	100	113
DGG-700	7		383	116	129
DGG-800	8		436	132	145
DGG-900	9		477	148	161
DGG-1000	10		541	164	177
DGG-1100	11		532	180	193
DGG-1200	12		632	196	209

T86加壓定量出油 Positive Displacement Injector System Distributor

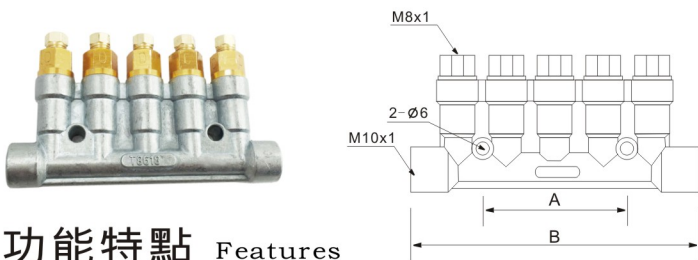

型號 Model	出油口數 Outlets	流量 Flow rate	重量(g) Weight	A	B
T8616	2	0.1 0.16	84	6	46
T8617	3		120	17	63
T8619	4		157	34	80
T8618	5	0.1 0.2 0.4 0.6	200	51	97
T8622	2		137	6	46
T8623	3		204	17	63
T8620	4		252	34	80
T8624	5		305	51	97

功能特點 Features

- 每次固定量精確供給潤滑部位。
- 不因油品黏度及打油時間長短影響流量。
- 配合容積式注油機使用。
- Each fixed amount is accurately supplied to the lubrication part.
- The flow rate is not affected by the viscosity of the oil and the length of oiling time.
- Used with positive displacement oiler.

DPB加壓定量出油 Positive Displacement Distributor

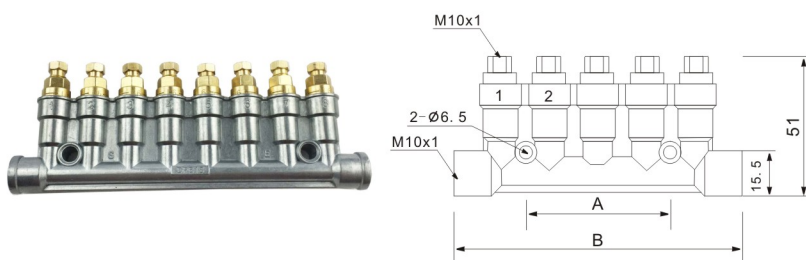

型號 Model	出油口數 Outlets	流量 Flow rate	重量(g) Weight	A	B
DPB-12	2	0.1 0.16 0.2 0.4	86	6.5	48
DPB-13	3		123	17	65
DPB-14	4		157	34	82
DPB-15	5		198	51	99
DPB-16	6		230	68	116
DPB-18	8		292	102	150
DPB-110	10		359	136	184

型號 Model	出油口數 Outlets	流量 Flow rate	重量(g) Weight	A	B
DPB-22	2	0.1 0.16 0.2 0.4	137	6	46
DPB-23	3		204	17	63
DPB-24	4		252	34	80
DPB-25	5		305	51	97
DPB-26	6		408	68	114
DPB-28	8		504	102	148
DPB-210	10		610	136	182

稀油抵抗式分配器

Resistance distributor

比例接头 Oil Flow Proportion Metering

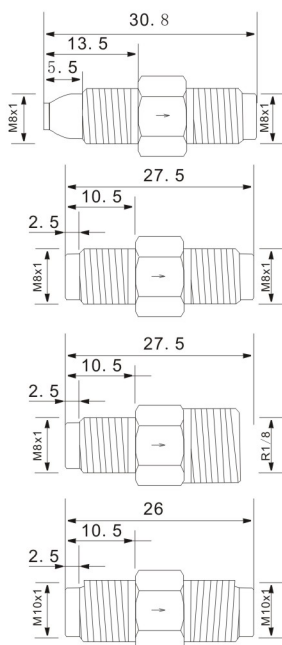

功能特点 Features

- 可按各个润滑点油量不同，选择不同规格的比例接头。
- 可稳定地将润滑油输送到每个润滑点。
- 具有止逆功能，可防止润滑油回流。
- 通过节流原理控制流量，按流通能力对流量进行比例分配。
- Variety of specifications for choose according to actual needs.
- Stable output of lubricant to the lubrication point.
- Include check valve to prevent lubricant backflow.

型号 Model	PSS	CSS	CST	PST
进油 Inlet	M8x1	M8x1	M8x1	M10x1
出油 Outlets	M8x1	M8x1	R1/8	M10x1
号数 Category No.	1 2 3 4 5			
流量比 Flow Ratio	4 8 16 32 64			
使用压力 Pressure	1.5~25kg/cm ²			
油黏度 Oil Viscosity	20~500cst.			

DGS/DGA 抵抗式分配器 Resistant Distributor

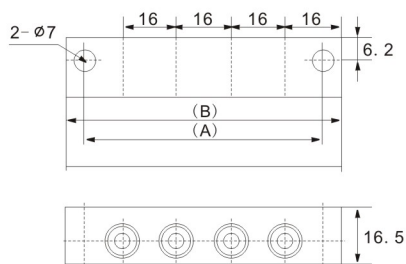
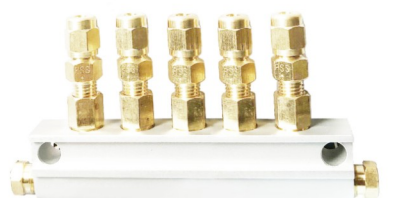

型号 Model	出油口数 Outlets	流量 Flow rate	重量(g) Weight	A	B
DGS-100	1	0.5 2 4 8 16 32 64	70	7	35
DGS-200	2		83	36	49
DGS-300	3		116	52	65
DGS-400	4		146	68	81
DGS-500	5		178	84	97
DGS-600	6		211	100	113
DGS-700	7		242	116	129
DGS-800	8		274	132	145
DGS-900	9		306	148	161
DGS-1000	10		339	164	177
DGS-1100	11		373	180	193
DGS-1200	12		403	196	209

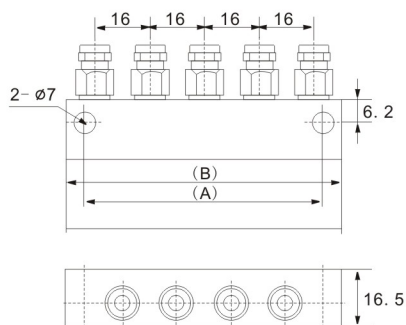

型号 Model	出油口数 Outlets	牙纹 Thread	重量(g) Weight	A	B
DGA-100	1	Inlet: M10x1 Outlets: M8x1	58	7	35
DGA-200	2		60	36	49
DGA-300	3		82	52	65
DGA-400	4		100	68	81
DGA-500	5		122	84	97
DGA-600	6		142	100	113
DGA-700	7		162	116	129
DGA-800	8		182	132	145
DGA-900	9		203	148	161
DGA-1000	10		225	164	177
DGA-1100	11		246	180	193
DGA-1200	12		267	196	209

B型抵抗式分配器 Adjustable Distributor

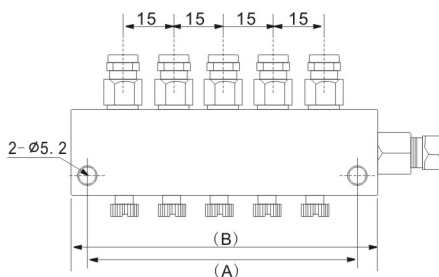

型号 Model	出油口数 Outlets	牙纹 Thread	重量(g) Weight	A	B
B-1-8	1	Inlet: M10x1 Outlets: M8x1	54	19	30
B-2-8	2		78	37	47
B-3-8	3		104	52	62
B-4-8	4		130	67	77
B-5-8	5		156	82	92
B-6-8	6		182	97	107
B-7-8	7		208	112	122
B-8-8	8		234	127	137
B-9-8	9		260	142	152
B-10-8	10		286	157	168
B-12-8	12		343	172	182

稀油抵抗式分配器

Resistance distributor

DGC型單面連接體 Distributor

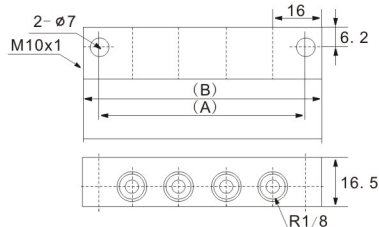

Model	Outlet number	A	B
DGC-2	2	36	49
DGC-3	3	52	65
DGC-4	4	68	81
DGC-5	5	84	97
DGC-6	6	100	113
DGC-7	7	116	129
DGC-8	8	132	145
DGC-9	9	148	161
DGC-10	10	164	177
DGC-11	11	180	193
DGC-12	12	196	203

A型單面連接體 Distributor

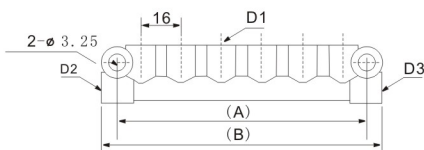

Model	Outlet number	D1=D2=D3	A	B
A-4-8	2	M8x1	35	50
A-4-10		M10x1		
A-5-8	3	M8x1	51	65
A-5-10		M10x1		
A-6-8	4	M8x1	68	86
A-6-10		M10x1		
A-7-8	5	M8x1	83	101
A-7-10		M10x1		
A-8-8	6	M8x1	98	116
A-8-10		M10x1		
A-9-8	7	M8x1	113	131
A-9-10		M10x1		
A-10-8	8	M8x1	128	146
A-10-10		M10x1		
A-12-8	10	M8x1	138	156
A-12-10		M10x1		

Ae型雙面連接體 Distributor

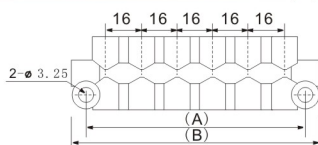

Model	Outlet number	A	B
AE-4-8	4	34	46
AE-6-8	6	50	62
AE-8-8	8	66	78

二通/三通/十字四通 Connector

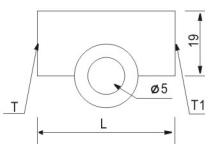

Model	OD	L	T	T1
2TD-8-8	4	28	M8x1	M8x1
2TD-10-10	6	28	M10x1	M10x1

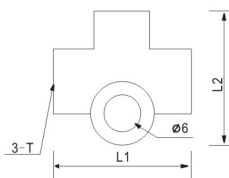

Model	OD	L1	T	L2
3TD-8-8	4	28	M8x1	19.5
3TD-10-10	6	30	M10x1	22

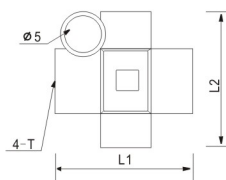

Model	OD	L1	T	L2
4TD-8-8	4	28	M8x1	28
4TD-10-10	6	30	M10x1	30

管套帽 Sleeve Unit

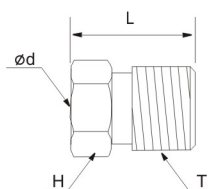

Model	OD	T	D	L	H
PA-3	3	M8x1	3.1	10	6
PA-4	4	M8x1	4.1	12	8
PA-6	6	M10x1	6.1	12.5	10
PA-8	8	M14x1.5	8.1	14	14
PA-10	10	M16x1.5	10.1	15	16

管套 Sleeve

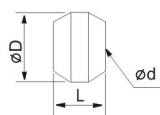

Model	OD	d	D	L
PB-3	3	3.1	4	2.6
PB-4	4	4.1	6	4.5
PB-6	6	6.1	8	4.5
PB-8	8	8.1	11	7
PB-10	10	10.1	13.5	8

直接頭 Straight Connector

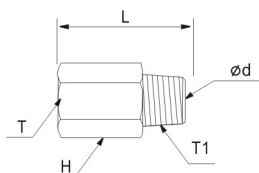
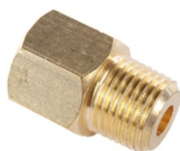

Model	OD	T1	T	H	L	d
PD404	4	M4x0.5	M8x1	10	17	2.5
PD405		M5x0.7				2.5
PD406		M6x1				2.5
PD406A		M6x0.75				2.5
PD408		M8x1				3
PD410		M10x1				3
PD418	R1/8	3				
PD608	6	M8x1	M10x1	12	20	4
PD610		M10x1				4
PD618		R1/8				4
PD812A	8	M12x1.25	M14x1.5	17	26	5
PD814		R1/4				6
PD818		R1/8				5
PD1018	10	R1/8	M16x1.5	18	22	5
PD1014		R1/4				7

單向直接頭 Single Way Straight Connector

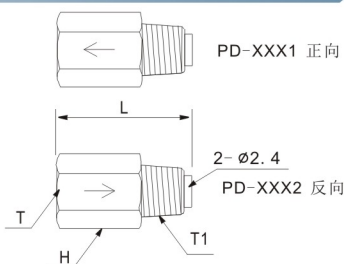

Model	OD	T1	T	H	L	d
PD4081	4	M8x1	M8x1	10	26	2.4
PD4082		M8x1				
PD4181		R1/8				
PD4182		R1/8				
PD6081	6	M8x1	M10x1	12	26	2.4
PD6082		M8x1				
PD6181		R1/8				
PD6182	R1/8					

彎接頭 Right Angle Connector

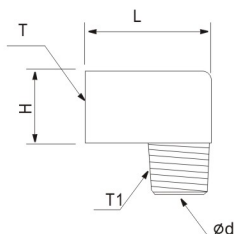
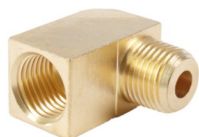

Model	OD	T1	T	H	L	d
PL404	4	M4x0.5	M8x1	10	18	2
PL405		M5x0.7				2
PL406		M6x1				2
PL406A		M6x0.75				2
PL408		M8x1				3
PL410		M10x1				3
PL418	R1/8	3				
PL608	6	M8x1	M10x1	12	20	4
PL610		M10x1				4
PL618		R1/8				4
PL812A	8	M12x1.25	M14x1.5	17	26	5
PL814		R1/4				6
PL818		R1/8				5
PL1018	10	R1/8	M16x1.5	19	29	5
PL1014		R1/4				7

潤滑系統配件

Accessories

單向彎接頭 Single Right angle connector

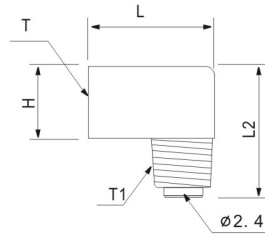

Model	OD	T1	T	H	L	d
PL4081	4	M8x1	M8x1	10	18	2
PL4181		R1/8				2
PL4082		M8x1				2
PL4182		R1/8				2
PL6181	6	R1/8	M10x1	12	20	4
PL6182		R1/8				4

平面直角接頭 Right Angle Connector

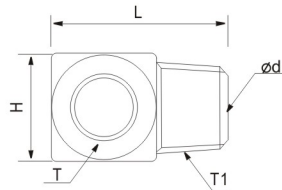

Model	OD	T1	T	H	L	d
PPL406	4	M6x1	M8x1	12.7	21	2
PPL408		M8x1			21	
PPL410		M10x1			21	
PPL418		R1/8			21	
PPL608	6	M8x1	M10x1		22.3	
PPL610		M10x1			22.3	
PPL618		R1/8			22.3	

活動直角接頭 Rotatable Right Angle Connector

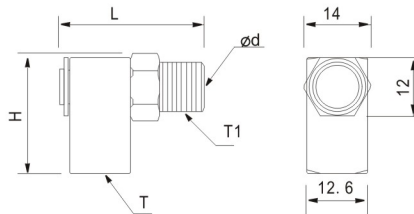
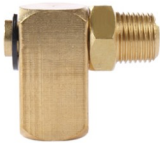

Model	OD	T1	T	H	L	d
PPL406	4	M6x1	M8x1	12.7	21	2
PPL408		M8x1			21	
PPL410		M10x1			21	
PPL418		R1/8			21	
PPL608	6	M8x1	M10x1		22.3	
PPL610		M10x1			22.3	
PPL618		R1/8			22.3	

正外接接頭 Right Angle Connector

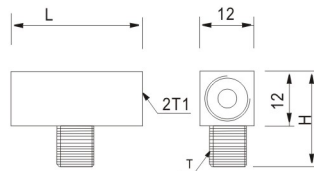

Model	OD	T1	T	H	L
3TG-8-8	4	M8x1	M8x1	21	25
3TG-8-10			M10x1		25
3TG-8-1/8			R1/8		27
3TG-10-8	6	M10x1	M8x1		28
3TG-10-10			M10x1		30

側外接接頭 Right Angle Connector

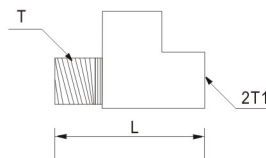

Model	OD	T1	T	L
3TZ-8-8	4	M8x1	M8x1	25
3TZ-8-10			M10x1	25
3TZ-10-8	6	M10x1	M8x1	27
3TZ-10-10			M10x1	28

過濾雙接頭 Filter Connector

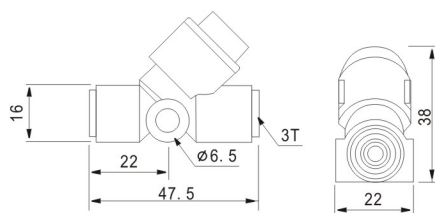

Model	FT04	FT06
OD	4mm	6mm
T	M8x1	M10x1
過濾精度 (U)	20	20
使用范围 Use range	Resistant system	Resistant system
压力 Max.pressure	25	25
流量 Discharge volume	1	1
用油范围 Lubricant	30-250	30-250

管襯套 Tube Sleeve

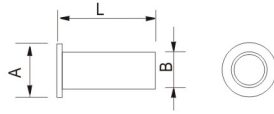

Model	OD	A	B	L
PT4*2	4	4	2	9
PT4*2.5			2.5	9
PT6*4	6	6	4	11
PT8*6	8	8	6	15.5
PT10*8	10	10	8	18

套管塞頭 Plug

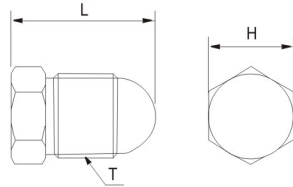

Model	OD	L	T	H
PS-8	4	16	M8x1	8
PS-10	6	17	M10x1	10

螺帽 Nut

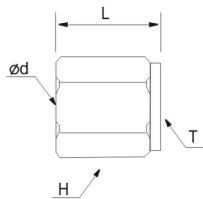

Model	OD	L	T	H
PN-4	4	13	M8x1	10
PN-6	6	13	M10x1	12

管夾 Pipe Clip

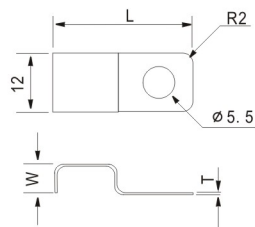

Model	OD	L	W	T	Tube number
PC1104	4	19	10	0.8	1
PC1106	6	20	10	0.8	1
PC1108	8	22	10	1	1
PC1110	10	26	10	1	1
PC1204	4	23	10	0.8	2
PC1206				2	2
PC1304	4	27	12	1	3

內、外牙接頭 Connector

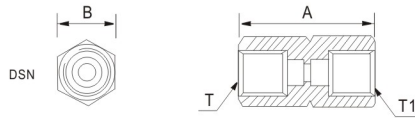

Model	A	B	T	T1
DSW4	23	10	M8x1	M8x1
DSW-6	25	12	M10x1	M10x1
DSN-4	24.5	10	M8x1	M8x1
DSN-6	24.5	12	M10x1	M10x1

萬向旋轉鉸接頭/孔內三通 Connector

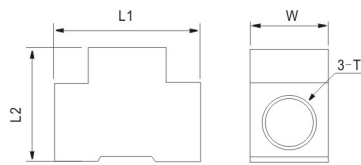
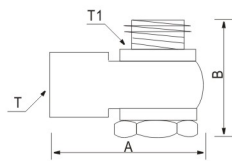

Model	OD	T	T1	A	B
PJH406	4	M8x1	M6x1	25	20
PJH408	4	M8x1	M8x1	25	20
PJH418	4	M8x1	R1/8	25	20
PJH608	6	M10x1	M8x1	28	23
PJH610	6	M10x1	M10x1	28	23

Model	T	L1	L2	W
3TF-8-8	M8x1	27	21	14
3TF-10-10	M10x1	31	25	18

黄油嘴 Grease nipple

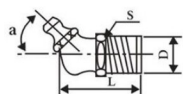

a = 0°: straight grease nipple
a = 45°: 45° elbow grease nipple
a = 90°: 90° grease nipple

Model	Material	D	a	L	S
HY-106	copper	M6x1	0°	12	8
HY-108	copper	M8x1		15	10
HY-110	copper	M10x1		17	11
HY-206	copper	M6x1	45°	16	10
HY-208	copper	M8x1		19	10
HY-210	copper	M10x1		19	11
HY-306	copper	M6x1	90°	16	10
HY-308	copper	M8x1		19	10
HY-310	copper	M10x1		22	11

壓注式油杯 Oil Cup



Model	Material	L	H
PYB-106	copper	6	6
PYB-108	copper	8	8
PYB-110	copper	10	10
PYB-112	copper	12	12
PYB-116	copper	16	16

彈蓋式油杯 Oil Cup

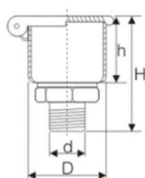

Model	Material	d	D	H	h
SYB-106-8	copper	M6x1	8	16	8
SYB-108-10	copper	M8x1	10	16	8
SYB-110-10	copper	M10x1	10	17	8
SYB-110-12	copper	M10x1	12	25	12
SYB-110-20	copper	M10x1	20	40	21

旋蓋式油杯 Oil Cup

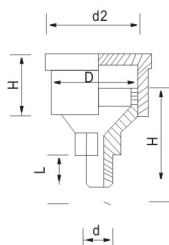

Model	Capacity	d	L	H	h	d1	D	d2	S
RYB-110-16	1.5	M10x1	8	14	22	3	16	M14x1.25	12
RYB-110-20	3			15	23		20	M18x1.25	14
RYB-110-26	6			17	26		26	M24x1.25	14
RYB-114-32	12	M14x1.5	10	20	30	4	32	M30x1.25	17
RYB-114-36	18			22	32		36	M34x1.25	17

彈蓋式直角油杯 Oil Cup

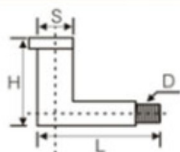

Model	Material	D	L	H	S
SYB-306	Nickel-plated	M6x1	25	18	8
SYB-308	Nickel-plated	M8x1	30	25	10
SYB-310	Nickel-plated	M10x1	35	25	10
SYB-318	Nickel-plated	R1/8	35	25	10

鏈條潤滑毛刷 Brush tool

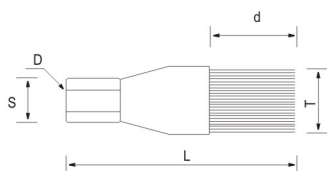

Model	D	d	t	L	S
OB-08A	M8x1 Female thread	40	20	78	12.5
OB-08B	M8x1 male thread			90	
OB-10A	M10x1 Female thread			88	
OB-10B	M10x1 male thread			90	

Lubricating Oil Hose

銅管
Copper Oil Hose



鋁鍍銅管
Aluminum Brass Crossing



鋁管
Aluminum Oil Hose



尼龍管
Nylon Oil Hose



Model	Material	OD				L
銅管 Copper Oil Hose	CP	4x1	6x1	8x1	10x1	50m/Roll
鋁鍍銅管 Aluminum Brass Crossing	ACP	4x2	6x4	8x6	10x8	100m/Roll
鋁管 Aluminum Oil Hose	AP	4x2	6x4	8x6	10x8	100m/Roll
尼龍管 Nylon Oil Hose	PA	4x2	6x4	8x6	10x8	100m/Roll

外鋼絲軟管

外鋼絲軟管使用橡膠管，
可在工作環境惡劣的場所下使用，
適用溫度範圍是-20~+80度

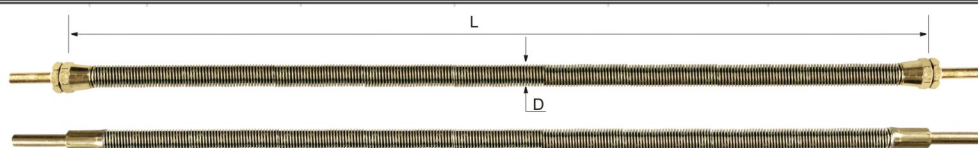

Model	OD	压力 (Mpa)	弯曲半径(mm)	D(mm)	L(mm)
OST-4	4	3.0	R20	11.5	按用户要求订制 Customized
OST-6	6	2.7	R40		

高壓樹脂管

耐壓樹脂管使用聚氨酯材料軟管，配合
黃油泵使用，可耐高壓力和在環境惡劣
的場所下使用，適用溫度範圍為-20~+80度



Model	OD	压力 (Mpa)	弯曲半径(mm)	D(mm)	L(mm)
OSP-4	4	25	R40	9.5	按用户要求订制 Customized
OSP-6	6				
OSP-8	8				

高壓軟管

鋼絲護套軟管是一種外套加密彈簧的尼龍管，
可耐高壓力和在環境惡劣的場所下使用，
適用溫度範圍為-20~+80度

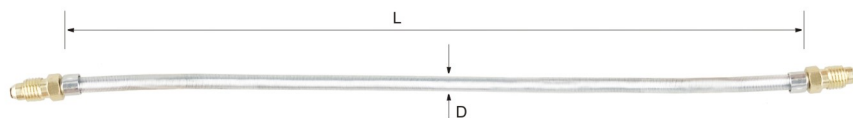

Model	OD	压力 (Mpa)	弯曲半径(mm)	D(mm)	L(mm)
OSM-4	4	3.0	R60	17	按用户要求订制 Customized
OSM-6	6	2.8		18	
OSM-8	8	2.8		20	

鋼絲護套

加密型
標準型
(0.5mm間隙)



Model	OD	長度/條	使用範圍
鋼絲護套	4/6/8	2m/4m	與尼龍管膠管配合使用

自動濾油器/泵配件

Filter/Accessories

濾油網

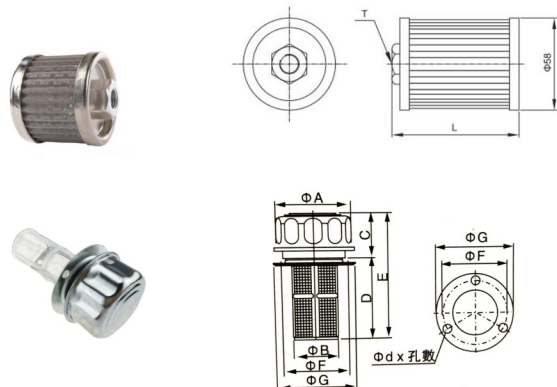

Model	T	L	过滤精度
MF-02	PS1/4	80	100
MF-03	PS3/8	80	100
MF-04	PS1/2	100	100
MF-06	PS3/4	133	100
MF-08	PS1"	158	100
MF-10	1-1/4"	178	100
MF-12	1-1/2"	194	100
MF-16	2"	210	100
MF-20	2-1/2"	274	100
MF-24	3"	274	100

Model	A mm	B mm	C mm	D mm	E mm	F mm	G mm	Dx孔数	过滤精度
HS-1162	53	31	31	68	99	45.5	53	30	40
HS-1163	80	48	47	90	137	71	92	92	40

過濾器



Model	Filtration	Flow Rate(L/min)	Max Working Preusse	Thread
FT-016	25	1.6L/min	3.5	R1/8
FT-017	60	1.6L/min	3.5	M10x1
FT-018	25	1.6L/min	3.5	M10x1

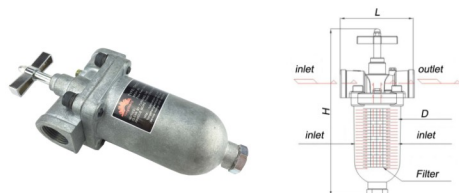

标准流量L/H							
Model	OD	60MESH	100MESH	H	L	D	材质
TK-102	1/4"	1940	760	160	75	55	Zinc alloy
TK-103	3/8"	1940	760	160	75	55	Zinc alloy
TK-310	3/4"	4730	1840	230	100	75	Zinc alloy
TK-312	1"	6270	2460	270	120	75	Zinc alloy

壓力開關/液位開關

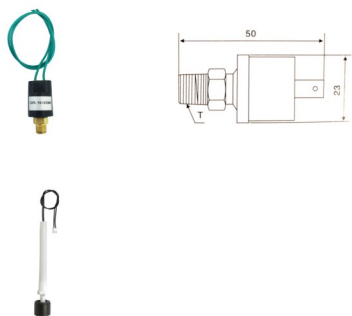

Model	规格	ON	OFF	牙纹	适用环境
压力开关 Pressure Switch	常开	10KG	5KG	M10x1	-10~ 80° C
	常闭				

Model	规格	输出接点	耐电压	最大通电流	牙纹	适用环境
液位开关 Level Switch	常开	50W	220V	1.5A	M10x1	-10~ 80° C
	常闭					

壓力表/油位鏡

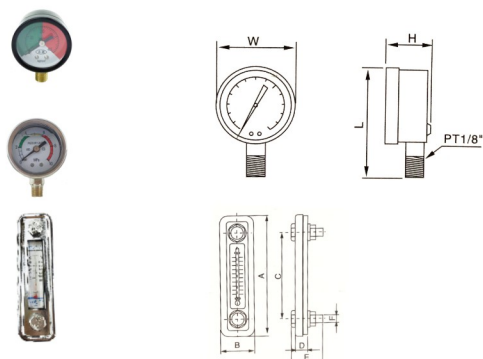

Model	规格 (kgf/cm2)	W	L	H	Thread
直立式压力表	40	40.7	57	23	M10x1
直接式充油压力表	100	46	63	25	M10x1

Model	A mm	B mm	C mm	D mm	E mm	F mm
LS-3	118	41	80	16.5	39	M10
LS-5	178	50	127	19	47	M12